

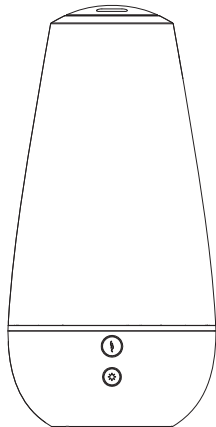

5 YEAR
WARRANTY

PURESPA XL

3-IN-1 AROMA DIFFUSER



USER MANUAL
MODEL: PESPAXL

Warnings & Cautions

1. This product can be used by children age 8 years and older and persons with reduced physical, sensory, or mental capabilities or lack of experience and knowledge if they have been given supervision or instruction concerning use of the product in a safe way and understand the hazards involved. Children shall not play with the product. Cleaning and user maintenance shall not be made by children without supervision.
2. Place the PureSpa XL on a flat surface about 2 feet away from the floor and 4 inches away from the wall. DO NOT place the diffuser on wooden furniture that can be damaged by water.
3. Be sure to turn off the product and disconnect the power adapter before cleaning the water tank.
4. Close the water tank cap tightly after each refill to prevent leaks and to ensure proper mist output.
5. Keep PureSpa XL out of the reach of children and pets.
6. Place the product in a clear space that allows the mist to flow freely away from appliances that are sensitive to water.
7. Always empty water and clean the water tank when the product is not in use.
8. Never open or move the product while it is running.
9. Avoid adding too many drops of essential oil.
10. DO NOT run the power cord under carpeting. DO NOT cover it with throw rugs, runners, or similar coverings. Arrange the cord away from foot traffic where it will not be tripped over.
11. DO NOT attempt to disassemble or modify the product in any way. Doing so could result in electric shock and serious injury.

Warnings & Cautions

12. Refill and clean the tank regularly for optimal performance.
13. Unplug the product during filling and cleaning.
14. The product is only to be used with the power supply unit provided with the product.

FCC Notice

Model: PureSpa XL 3-in-1 Aroma Diffuser (PESPAXL)

This device complies with part 18 of the FCC Rules.

Pure Enrichment
2803 S Yale St.
Santa Ana, CA 92704

This equipment generates, uses and can radiate radio frequency energy and, if not installed and used in accordance with the instructions, may cause harmful interference to radio communications. The equipment should be maintained as discussed in this manual. Changes or modifications not expressly approved by Pure Enrichment will void the user's authority to operate the equipment. If this equipment does cause harmful interference to radio or television reception, which can be determined by turning the equipment off and on, the user is encouraged to try to correct the interference by one or more of the following measures:

- Reorient or relocate the receiving antenna.
- Increase the separation between the equipment and receiver.
- Connect the equipment into an outlet on a circuit different from that to which the receiver is connected.
- Consult the dealer or an experienced radio/TV technician for help.

Introduction

Thank you for purchasing PureSpa XL from Pure Enrichment. This 3-in-1 ultrasonic humidifier, aroma diffuser and mood light packs three great features into one sleekly designed product. Just add a few drops of your favorite essential oil to deodorize any room and infuse a pleasant aroma.

Features:

Aromatherapy—PureSpa XL uses advanced ultrasonic technology to produce high frequency vibrations that turn water and essential oil into a therapeutic mist that creates a soothing atmosphere.

Humidifier – Gently moisturizes and refreshes the quality of air in the room.

Rainbow Spectrum Mood Light— Creates a tranquil ambiance that supports relaxation and a restful night's sleep.

Ionizer – Produces "happy feeling" negative ions which are believed to lift your mood, strengthen the immune system, and relieve stress.

Accessories:

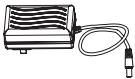

ETL-Approved Adapter

Product Diagram

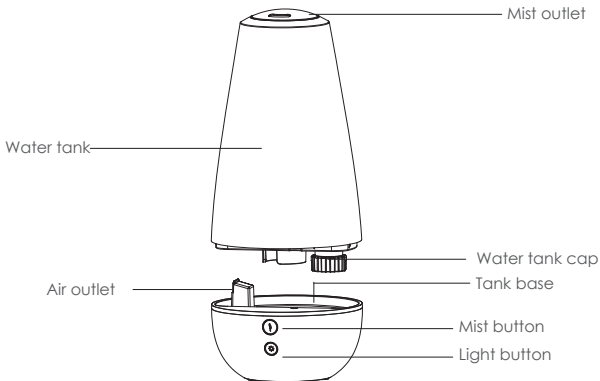

Specifications

Power	100-240V, 50/60Hz, 12W
Dimensions	12" x 5.9"
Weight	1.6 lbs
Water Tank Capacity	2 Liters
Aroma Coverage	Up to 350 ft ²
Mist Output	≤70ml/hr (low); ≤120ml/hr (high)
Run Time*	≤50 hrs (low); ≤22 hrs (high)
Mist Mode	High & Low Mist Settings
Light Settings	Fixed or Rotating Colors
LED Lights	Multi color-changing lights (Red, Pink, Orange, Green, Yellow, Purple, Blue & More)

*Run time may vary depending on water quality, room temperature, and amount of oil added to PureSpa XL.

Setting Up PureSpa XL

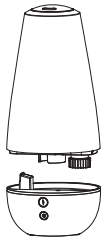

1. Remove the water tank.

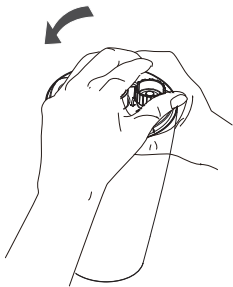

2. Twist the water tank cap counterclockwise to open.

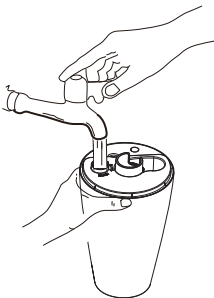

3. Fill the tank with water.

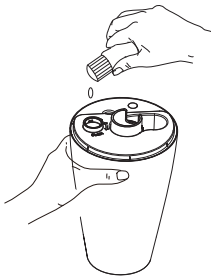

4. Add 10-20 drops of 100% pure essential oil to the water tank.

NOTE: Fragrance strength will vary depending on the number of drops added and the amount of water in the tank.

Setting Up PureSpa XL

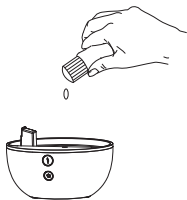

5. **AROMATHERAPY TIP:** For a **boost** to your essential oil aroma, add a little water plus a few drops of oil to the base (optional).

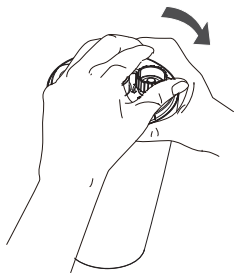

6. Twist the water tank cap clockwise until securely fastened

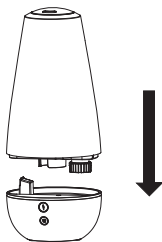

7. Place the water tank back on the base

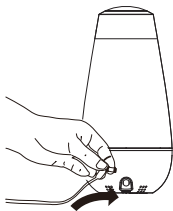

8. Connect the AC power adapter

Operating PureSpa XL

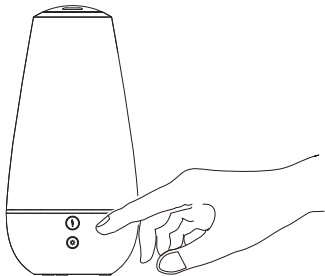

8. Press  to turn the aroma diffuser ON/OFF and to adjust the mist output:

1st press: High mist output

2nd press: Low mist output

3rd press: Turn off mist

9. Press  to control the mood light:

1st press: Turn on the color-changing mood light;

2nd press: Set the light on your favorite color when it appears in rotation

3rd press: Turn off the light

NOTE:

The mist and light buttons function independently. You can use the mood light without turning on the aroma diffuser and vice versa.



TROUBLESHOOTING TIP

PureSpa XL will power off automatically when the water runs out, and the light will flash red three times. **Refill the water tank to continue using.**

Cleaning & Maintenance

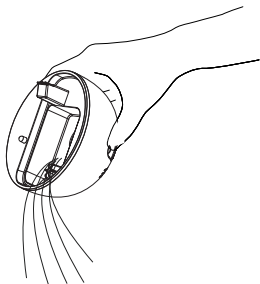

10. Turn the power OFF and unplug the unit from the electrical outlet. Lift off the water tank.

11. Drain and rinse the water tank thoroughly to remove any sediment and dirt. Wipe clean and dry with a clean soft cloth.

NOTE:

1. DO NOT add water through the mist outlet (as shown in picture a below).
2. DO NOT fill water into the air outlet (as shown in picture b below).
3. Refill the water tank when the water runs out.
4. Add more drops of 100% pure essential oil when the scent gets weak.
5. Deep clean the base tank and water tank once a week.
6. DO NOT move the device while operating, or it will cause the water in the base to overflow, which will lead to NO MIST or small mist. If it overflows, pour out the water in the base tank, and then operate the device again.

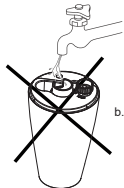
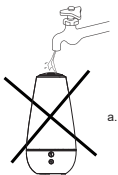

Using Essential Oils with PureSpa XL

To avoid unnecessary damage to PureSpa XL, or harm to you or others, please keep the following recommendations in mind when using essential oils:

- DO NOT exceed 10-20 drops of essential oil per 2 liters of water.
- Avoid spilling essential oil on your skin. If you do, immediately dilute it with a carrier oil like coconut oil or olive oil. If swallowed, seek medical help immediately.
- Clean the water tank after each use. Some essential oils are not water-soluble and may remain in the water tank causing residue or an unpleasant odor if mixed with another essential oil.
- Immediately discontinue the use of any essential oil that makes you feel sick or produces an adverse side effect.
- Pregnant women, elderly people, young children or people with chronic diseases may be more sensitive to a particular fragrance.
- Store essential oil in a cool, dry place with the cap tightly closed and out of the reach of children and pets.
- Observe the expiration date of your essential oil. For most oils, the standard expiration date is one year from first opening. Citrus oils have a six-month expiration.

Warranty Information and Product Registration

WARRANTY

This product comes with an industry-leading 5 Year Warranty that begins on the date of purchase.

The warranty applies to the aroma diffuser/humidifier/mood light and necessary parts and labor relating thereto. The warranty does not apply to damage resulting from failure to follow the operating instructions, accidents, abuse, alterations or disassembly by unauthorized individuals.

PRODUCT REGISTRATION

To ensure your full warranty and to receive product updates and streamlined customer support, remember to register your product at:

[www.pureenrichment.com/product registration](http://www.pureenrichment.com/product-registration)

ARE YOU 100% SATISFIED?

If you have product questions or concerns don't hesitate to contact us directly at:

Email: help@pureenrichment.com

Phone: (657) 275-3737

(Available Monday-Friday, 8am-5pm PST)

Pure Enrichment has an award-winning warranty, exchange, and customer service program that guarantees hassle-free solutions to any issue you might have within 24 hours!



Santa Ana, CA 92704
pureenrichment.com

REV: 04-2021