

pore
enrichment

2 YEAR
WARRANTY

PUREPULSE PRO

ADVANCED TENS MUSCLE STIMULATOR



USER MANUAL
MODEL: PEPULSEPRO

TABLE OF CONTENTS

WARNINGS AND PRECAUTIONS	3-5
FCC NOTICE	6
INTRODUCTION AND WHAT'S IN THE BOX	7
USING PUREPULSE PRO	8
• Inserting/Changing the Batteries	8
• Applying the Electrode Pads	9
• Removing the Electrode Pads	9
• Turning ON the Device	9
• Turning OFF the Device	10
• Selecting the Program	10
• Selecting the Therapy Intensity Level	11
EXTRA FEATURES.....	12
CARE AND MAINTENANCE.....	13
ACCESSORIES AND REPLACEMENT PARTS.....	14
TROUBLESHOOTING & TECHNICAL SPECIFICATIONS	15
WARRANTY & REGISTRATION.....	16

WARNINGS AND PRECAUTIONS

Read this manual before using.

Read instruction manual before operation. Be sure to comply with all “CAUTIONS” and “WARNINGS” in the manual. Failure to follow instructions can cause harm to user or device.

Do NOT use the PurePulse Pro if any of the following conditions are present:

- Do not use this Device if you have a cardiac pacemaker, implanted defibrillators or any other implanted metallic or electronic device.
- Do not use this Device if you have undiagnosed chronic pain.
- Do not use if you are pregnant.
- Do not use if you suffer from cancer, epilepsy, ischemia, or other serious conditions. If you are unsure, consult your physician.

Warnings and Precautions for the proper use and safety of the PurePulse Pro:

- If you are under the care of a doctor, consult with your physician before using this Device.
- Do not apply stimulation over the throat. Severe spasm of the muscles may occur and the contractions may be strong enough to cause difficulty in breathing. Stimulation over the neck/throat could also have adverse effect on hearing or blood pressure.
- Do not apply stimulation across the chest because the introduction of electrical current into the chest may cause rhythm disturbances to the heart.
- Do not place the pads on your head.
- Do not use this Device while sleeping.
- Do not use if you feel numbness.
- Do not use in or close to water.
- Keep your Device out of the reach of children.
- Use the pads only on normal, healthy, clean and dry skin. Do not use the pads on open wounds or rashes, or over swollen, red, infected or inflamed skin.
- PurePulse Pro is intended for individual person use.

WARNINGS AND PRECAUTIONS

- PurePulse Pro is not effective for pain associated with Central Pain Syndromes, such as headaches.
- PurePulse Pro is for temporary relief of pain caused by muscle soreness, and should be placed only around muscles where pain originates.
- The effectiveness of the PurePulse Pro depends greatly on a person's individual physical condition and body type. Effectiveness will differ for each user.
- Skin irritation and burns under the pads have been reported by some people who have applied electronic stimulators to their skin.
- Minor redness at stimulation placement is a normal skin reaction. It is not considered as skin irritation, and it will normally disappear within 30 minutes after the electrodes are removed. If the redness does not disappear after 30 minutes from the removal of electrodes, do not use the stimulator again until after the excessive redness has disappeared.
- If skin under one or more pads feels irritated after using the stimulator for a long period of time, use the stimulator for a shorter period of time.
- Turn off the stimulator if the stimulation feels unpleasant or does not provide temporary pain relief.
- Use your stimulator only with the pads, snap cables and accessories recommended by the manufacturer.
- Do not use when driving, operating machinery or when swimming.
- Before removing the belt and pads, be sure to turn OFF both power knobs to avoid unpleasant stimulation.
- PurePulse Pro is a battery-operated electronic Device. Its output performance and safety may be affected greatly in extreme humidity, therefore it is important to keep the stimulator dry to ensure its safety and performance.



Use caution and consult your Physician before using PurePulse Pro if any of the following conditions apply to you:

- If you have suspected or diagnosed heart problem.
- If you have suspected or diagnosed epilepsy.
- If you have a tendency to bleed internally following an injury.
- If you recently had surgery, or have ever had surgery on your back.
- If areas of skin lack normal sensations, such as skin that tingles or is numb.

WARNINGS AND PRECAUTIONS

- If you have numbness, tingling, swelling, or loss of feeling/sensation in your arms, hands, legs or feet.
- During menstruation or during pregnancy.
- If you have had medical or physical treatment for your muscle pain, consult with your treatment provider before using the PurePulse Pro. You should contact your physician prior to using this device following recent surgical procedures. Stimulation may disrupt the healing process.
- If your pain does not improve, becomes more than mild or if it continues for four to six days, stop using this Device and consult your Physician.

Important:

- Do not use PurePulse Pro at the same time with any other device that transfers an electrical current into the body (e.g. another muscle stimulator).
- Stop using your unit if you are feeling light headed or faint. Consult doctor if this happens.
- Do not touch the pads or metal studs while the unit is switched on.
- Do not use unit if you are wearing a belly button ring. Remove ring before session.

Electrode Pad Precautions

- To reposition the pads during a session, always pause the program currently running, reposition the pads as directed and then restart the program again.
- Only use PurePulse Pads supplied by Pure Enrichment with your device. Any others may not be compatible with your unit and could degrade the minimum safety levels.
- Pads are built for 15-25 uses or until they no longer stick.
- Do not plunge the pads into water.
- Do not apply solvents of any kind to the pads.
- Always ensure the unit is OFF before removing the pads.
- Apply the whole surface of the pads firmly to the skin. Do not use pads which do not adhere properly to the skin.
- If your skin is red under the pad after a session, do not start another session in the same area until your redness has completely disappeared.

FCC NOTICE

Model: PurePulse Pro Advanced TENS Muscle Stimulator (PEPULSEPRO)

This device complies with part 15 of the FCC Rules. Operation is subject to the following two conditions: (1) This device may not cause harmful interference, and (2) this device must accept any interference received, including interference that may cause undesired operation.

Pure Enrichment
2803 S. Yale St.
Santa Ana, CA 92704
pureenrichment.com

The product is protected against unauthorized use. DO NOT modify it without the authorization of the manufacturer, or the user's authority to operate could be voided.

Note: This equipment has been tested and found to comply with the limits for a Class B digital device, pursuant to part 15 of the FCC Rules. These limits are designed to provide reasonable protection against harmful interference in a residential installation. This equipment generates, uses and can radiate radio frequency energy and, if not installed and used in accordance with the instructions, may cause harmful interference to radio communications. However, there is no guarantee that interference will not occur in a particular installation. If this equipment does cause harmful interference to radio or television reception, which can be determined by turning the equipment off and on, the user is encouraged to try to correct the interference by one or more of the following measures:

- Reorient or relocate the receiving antenna.
- Increase the separation between the equipment and receiver.
- Connect the equipment into an outlet on a circuit different from that to which the receiver is connected.
- Consult the dealer or an experienced radio/TV technician for help.

INTRODUCTION

Thank you for purchasing PurePulse Pro! This professional-grade electronic pulse massager is used for temporary muscle and joint pain management.

Our portable, easy-to-use device comes with all the essentials you need to address discomfort throughout your body.

WHAT'S IN THE BOX

- 1 PurePulse Pro TENS Device
- 1 Clip Holder
- 4 Self-adhesive Electrode Pads (size 2" x 2")
- 3 AAA Batteries
- 2 Lead Connectors
- 1 Soft Storage Bag

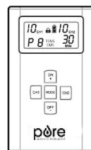

1

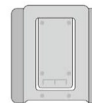

2

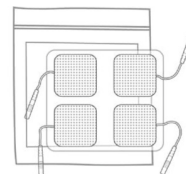

3



4



5

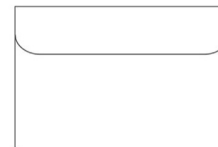

6

USING PUREPULSEPRO

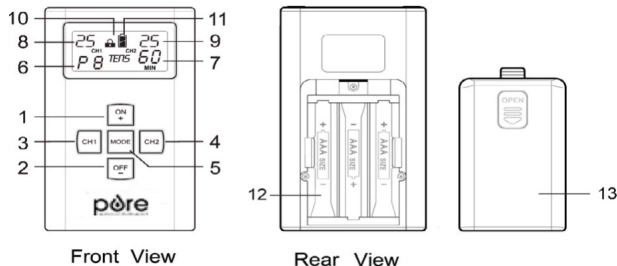

1. Power On / Adjust / Increase Setting
2. Power Off / Adjust / Decrease Setting
3. CH1 (Channel 1) Select
4. CH2 (Channel 2) Select
5. Therapy Time/Mode/Program Selection
6. Program Number
7. Therapy Time Remaining
8. CH1 Intensity Level
9. CH2 Intensity Level
10. Lock Status Indicator
11. Battery Status Indicator
12. Battery Compartment
13. Battery Cover

Inserting/Changing the Batteries



1. To open the battery compartment, which is located on the back of the device, press downward on the raised arrow below "Open" on the battery cover.
2. Insert 3 AAA (1.5 V) batteries in the battery compartment using the + and - guides printed inside the device.
3. Reattach the battery cover by sliding upward and clicking it into place.

Applying the Electrode Pads

1. Clean skin thoroughly before applying the electrode pads. Electrode pads do not stick well if any lotions, oil, makeup, dirt, etc. are left on the skin.
2. While still on the plastic liner, plug each electrode pad into the lead connectors, and then plug the lead connector into PurePulse Pro. Always connect the electrode pads to the device before applying to the skin.
3. Remove the electrode pads from the protective plastic liner and apply firmly to the skin.

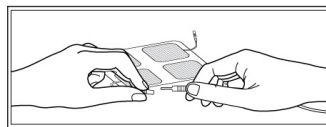

Removing the Electrode Pads

1. Lift at the edge of the electrode pad and peel. Do not pull on the lead wires when removing from the skin.
2. Place the electrode pads back on the plastic liner and disconnect the lead wire by twisting and pulling at the electrode wire connectors.

Turning On the Device

1. Press and hold the ON+ button for one (1) second to turn on the device.
2. The most recently selected treatment time and program will flash when the unit is turned on.

▲ Note: Do not turn the unit on until all electrodes and lead wires are properly attached.

▲ Note: When stimulating the muscles of the arms or legs, note that the muscle contraction may cause involuntary limb movement. Always ensure the limb is secured to prevent movement.

Turning Off the Device

1. The device turns off automatically after the therapy session time has elapsed.
2. To turn the unit off manually, hold the OFF- button for three (3) seconds. The display will go blank and the device will turn off.
3. In an emergency, you may also pull the connector(s) from PurePulse Pro.

▲ **Note:** To prevent unpleasant electric shocks, never remove the electrode pad while the device is still turned on.

Selecting the Program

PurePulse Pro offers 8 different pre-set treatment programs. The programs differ with respect to varying pulse widths and frequencies. The mode setting depends on user preference and condition. To select your preferred mode, use the following steps:

1. Press MODE the pre-set (default) program will flash on the display (fig.1).
2. To increase or decrease the Program, press the button ON + (to increase) or the button OFF - (to decrease) repeatedly until the desired treatment mode is displayed (fig.2).
3. Press MODE again to save your selection. The program you selected will appear on the display the next time you turn the device on.

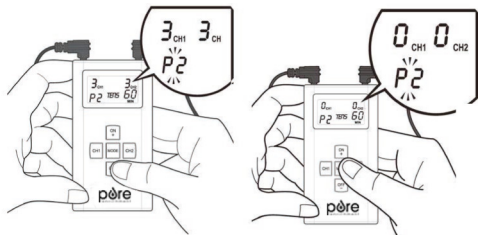

PurePulse Pro Treatment Program Modes

Program/ mode	Benefits	You should feel
P1	Temporary pain relief associated with muscle groups	Continuous comfortable tingling. The underlying pain should decrease temporarily after treatment.
P2	Help relieve muscle twitching	Comfortable pulsing sensation. The underlying pain should temporarily decrease almost immediately.
P3	Temporary pain relief associated with muscle groups	Comfortable pulsing sensation. The underlying pain should temporarily decrease almost immediately.
P4	Massage-like feeling	Variable comfortable tingling and pulsing sensation (sensation should appear to come in waves). Pain should ease and there should be temporary relief after treatment.
P5	Decrease of muscle fatigue at high intensity Massage-like feeling	Variable comfortable mild tingling sensation (sensation will appear to come in waves).
P6	Decrease of muscle fatigue Massage-like feeling	Variable comfortable pulsing and pumping action (action will appear to come in waves).
P7	Prevents accommodation or habituation Massage-like feeling	Variable comfortable tingling and pumping action (action should appear to come in waves).
P8	Combination of program P1 to P7 Massage-like feeling	For temporary pain relief associated with muscle groups, helps prevent accommodation or habituation

Selecting the Therapy Intensity Level

1. Intensity is adjustable within each channel separately. Select the channel you wish to adjust by pressing CH1 or CH2. "CH1" or "CH2" will flash on the display.
 2. To increase or decrease the intensity, press ON + (to increase) or OFF - (to decrease) repeatedly until the desired intensity level flashes on the display.
- ▲ **Note:** You will feel the intensity increase or decrease as you select the intensity level. You can use this as a guide to select a level that is comfortable for you.
3. Press MODE to save your selection.

EXTRA FEATURES

Treatment Time

The device offers 12 pre-set times: 5, 10, 15, 20, 25, 30, 35, 40, 45, 50, 55 and 60 minutes. Time will countdown on the display in 1-minute increments for the duration of your session.

To Select a Treatment time:

1. Press MODE. The pre-set (default) treatment time will flash on the display.
2. To increase or decrease the treatment time, press the button ON + (to increase) or the button OFF – (to decrease) repeatedly until the desired duration appears on the display.
3. Press MODE again to save your selection. The treatment time you selected will appear on the display the next time you turn the device on.

▲ Note: If you change programs during the course of a therapy session, the treatment time will not reset unless you manually reset it by performing the steps described above.

Lock Function

Press and hold the ON + and OFF – keys simultaneously for 1 second to lock/unlock the device.

Automatic Shut off

The device automatically turns off when no button is pressed for 60 seconds. The device automatically turns off when the time for your therapy session has elapsed.

Intensity Level Reset

For your safety and comfort, the intensity level will reset to 0 each time the device turns off, including after therapy sessions.

Low Battery Status Indicator

The battery status indicator will light whenever the battery is low. This means that you will have to replace the batteries shortly.

CARE AND MAINTENANCE

PurePulse Pro Device

The PurePulse Pro Device may be wiped clean with a small amount of soapy water on a clean cloth. Do not submerge the stimulator in liquids or expose it to large amounts of water.

- Never use aggressive cleaning products or stiff brushes to clean the device.
- Remove the batteries before cleaning the device.
- Do not use the device again until it is completely dry.
- Do not expose the device to direct sunlight and protect it from dirt and moisture.

Cables

- Disconnect the cables from the stimulator and electrodes.
- Do not pull on the cables, but on the connectors attached to the ends of the cables.
- Store the PurePulse Pro with the cables in a clean, dry place.

Electrodes

The electrode pads are disposable and use an adhesive that will dry out after prolonged usage or storage. Pads should be replaced when they lose their adhesive quality, or you sense a change in stimulation sensation.

To order replacement pads, please visit www.pureenrichment.com or contact an authorized dealer.

How to Store PurePulse Pro

- Store your Device in the provided bag at room temperature in a dry place. Keep out of the reach of children.
- If the stimulator will not be used for more than a week, remove the batteries while storing.

ACCESSORIES AND REPLACEMENT PARTS

PurePulse Therapy Belt

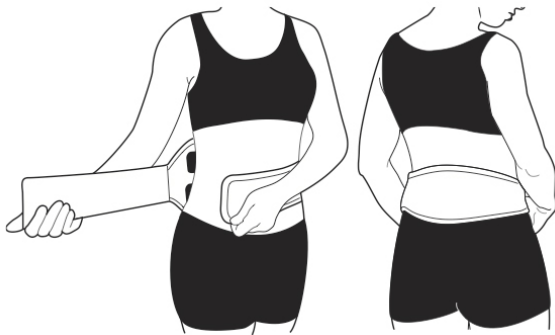

The PurePulse Therapy Belt is the ideal accessory for people with lower back pain. This adjustable belt connects directly to PurePulse Pro and has built-in electrodes that eliminate the need to purchase additional pads. Simply insert PurePulse Belt's connector plugs into the sockets at the top of PurePulse Pro.

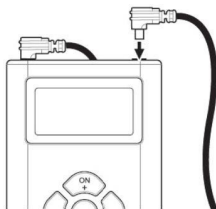

To purchase the PurePulse Therapy Belt, additional pads, and replacement parts, visit pureenrichment.com.

TROUBLESHOOTING

If you are having problems with your PurePulse Pro, make sure the cables fit tightly into the connection sockets of the device and that the batteries have sufficient charge and are not corroded.

ADDITIONAL TECHNICAL SPECIFICATIONS

Channel:	Dual, isolated between channels
Output Voltage:	0-40V ($\pm 10\%$) peak into 500 Ω load each channel (1.34Vrms/max.)
Pulse Amplitude:	Adjustable 0 – 80mA ($\pm 10\%$) (1.3mA _{rms} /max.)
Pulse Rate:	As pre-programming operation mode
Pulse Width:	As pre-programming operation mode
Software Ramp Up Feature:	Pulse width ramp up when change mode
Timer:	5-60 min. selectable
LCD:	Show modes, pulse rate, pulse width, timer, CH1/CH2, intensity level
Wave Form:	Symmetrical Bi-Phasic square pulse
Max Charge per Pulse:	20.8 micro-coulombs maximum
** All electrical specifications are $\pm 20\%$ at 500 Ω load.	
Operating Conditions:	50°F (10°C) to +104° (40°C), 40-90% Maximum Relative Humidity
Transportation & Storage Condition:	+14°F (-10°C) to +140° (60°C), 30-95% Maximum Relative Humidity
Operation Altitude:	3000m
Atmospheric Pressure Range:	80kPa to 101.3kPa
Weight:	2 ounces
Dimensions:	3.5" x 2" x 0.75"

WARRANTY

PurePulse Pro comes with an industry leading 2 Year Warranty from the date of purchase.

The warranty applies to PurePulse Pro and necessary parts and labor relating thereto. The warranty does not include the electrode pads, which do need to be replaced over time.

The warranty does not apply to damage resulting from failure to follow the operating instructions, accidents, abuse, alterations or disassembly by unauthorized individuals.

PRODUCT REGISTRATION

To ensure your full warranty, receive product updates, and streamlined customer support, don't forget to register your product at:

pureenrichment.com/productregistration

ARE YOU 100% SATISFIED?

If you have product questions or concerns, don't hesitate to contact us directly at:

Email: help@pureenrichment.com

Phone: (657) 275-3737

(Available Monday-Friday, 8am-5pm PST)

Pure Enrichment has an award-winning warranty, exchange, and customer service program that guarantees hassle-free solutions to any issue you might have within 24 hours!



Santa Ana, CA 92704
pureenrichment.com